

## THERMAL LINEAR ACTUATORS

PAS linear actuators are designed with integrators in mind. The linear actuators offer multiple mounting configurations to make integration into any automated system effortless. State-of-the-art 3D CAD files for all PAS actuators are available in multiple file types to allow designers the ability to simply drop the actuator into their current machine design. Actuators are available with multiple forces and strokes to fit your specific automation needs.

### OPERATIONAL AND DESIGN FEATURES

- **Standard PAS columns available**
- **Multiple configurations available**
- **1/4 ton to 2 ton actuators available**
- **Modular Thermal power supplies up to 12 zones**
- **Optional system controller with large operator interface**
- **Standard tooling bolt patterns work with any model PAS machine**
- **Multiple mounting access points on any axis or plane**
- **Hydraulic dampener**



# SPECIFICATIONS

## CYLINDER BACK SIDE VIEW

REVISIONS			
REV.	DESCRIPTION	DATE	APPROVED

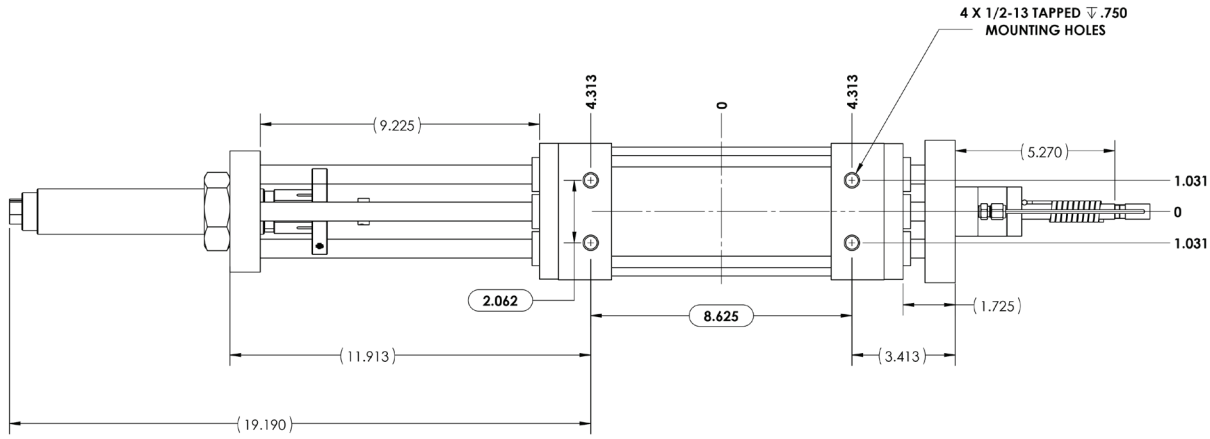

### NOTE

ALL DIMENSIONS IN PARENTHESIS ARE APPROXIMATE.

Shop Time (hrs)	UNLESS OTHERWISE SPECIFIED DIMENSIONS ARE IN INCHES TOLERANCES ARE:	CONFIDENTIAL DOCUMENT	Plastic Assembly Systems 12 Sargent Drive Bethany, CT 06524 866-863-1700
	FRACTIONS DECIMALS ANGLES	CAD GENERATED DRAWING DO NOT SCALE DRAWING	
	1/32 .001 .001		
	XXX .005 .001		
	XXXX .001		
Material Cut Size	Quantity	DATE	<b>PAS .50AS ACTUATOR ASSEMBLY</b>
X X		PH 1/3/19	Custom modification for PAS .50AS
		CHECKED	D PAS .50AS-ACTUATOR-ASSEMBLY (SHEET 1)
		DATE	Scale: 1:1 Weight: 0.00

P:\M-ENGINEERING\...PAS STANDARD\z. OLD STUFF\_NEEDS TO BE GONE THRU\2015 50AS\ACTUATOR DUMMY FILE\50AS-ACTUATOR-ASSEMBLY

## PAS .50AS ACTUATOR ASSEMBLY

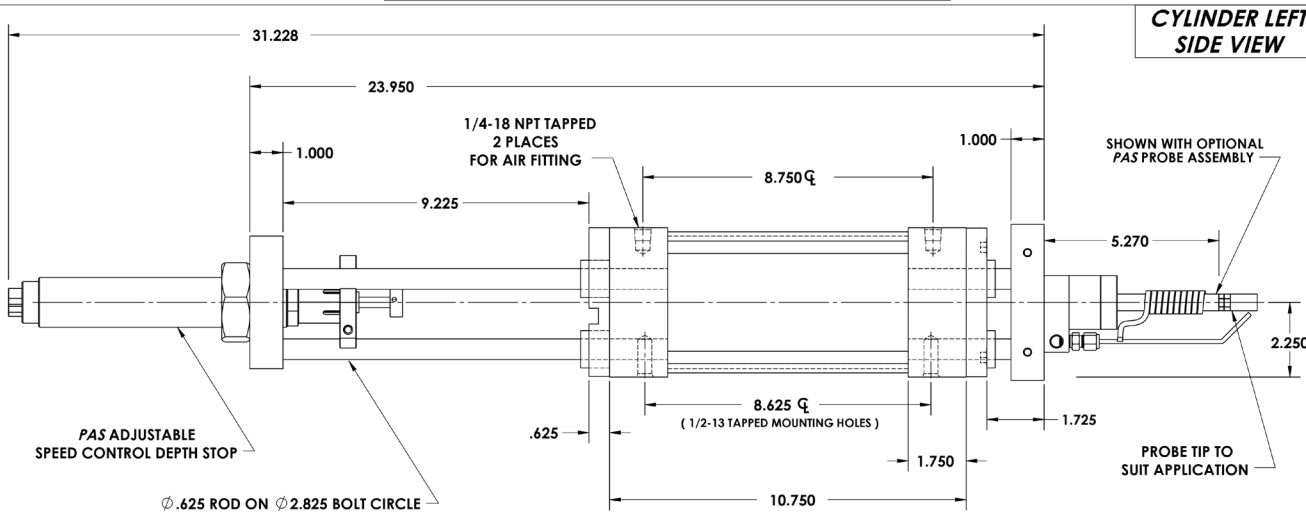

### CYLINDER RETRACTED

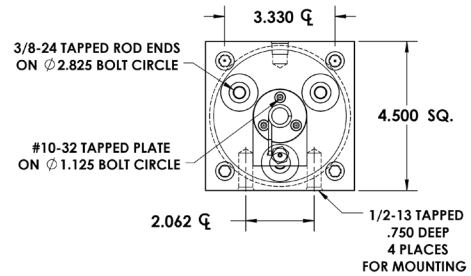

### NOTES

- 1) ALL DIMENSIONS ARE IN INCHES UNLESS OTHERWISE SPECIFIED.
- 2) ACTUATORS ARE AVAILABLE IN LARGER & SMALLER BORES & STROKES.
- 3) PLASTIC ASSEMBLY SYSTEMS RESERVES THE RIGHT TO CHANGE SPECS. WITHOUT NOTICE.

# SPECIFICATIONS

## PAS .50AS ACTUATOR ASSEMBLY

